

TIP PROJECT: W-5705G

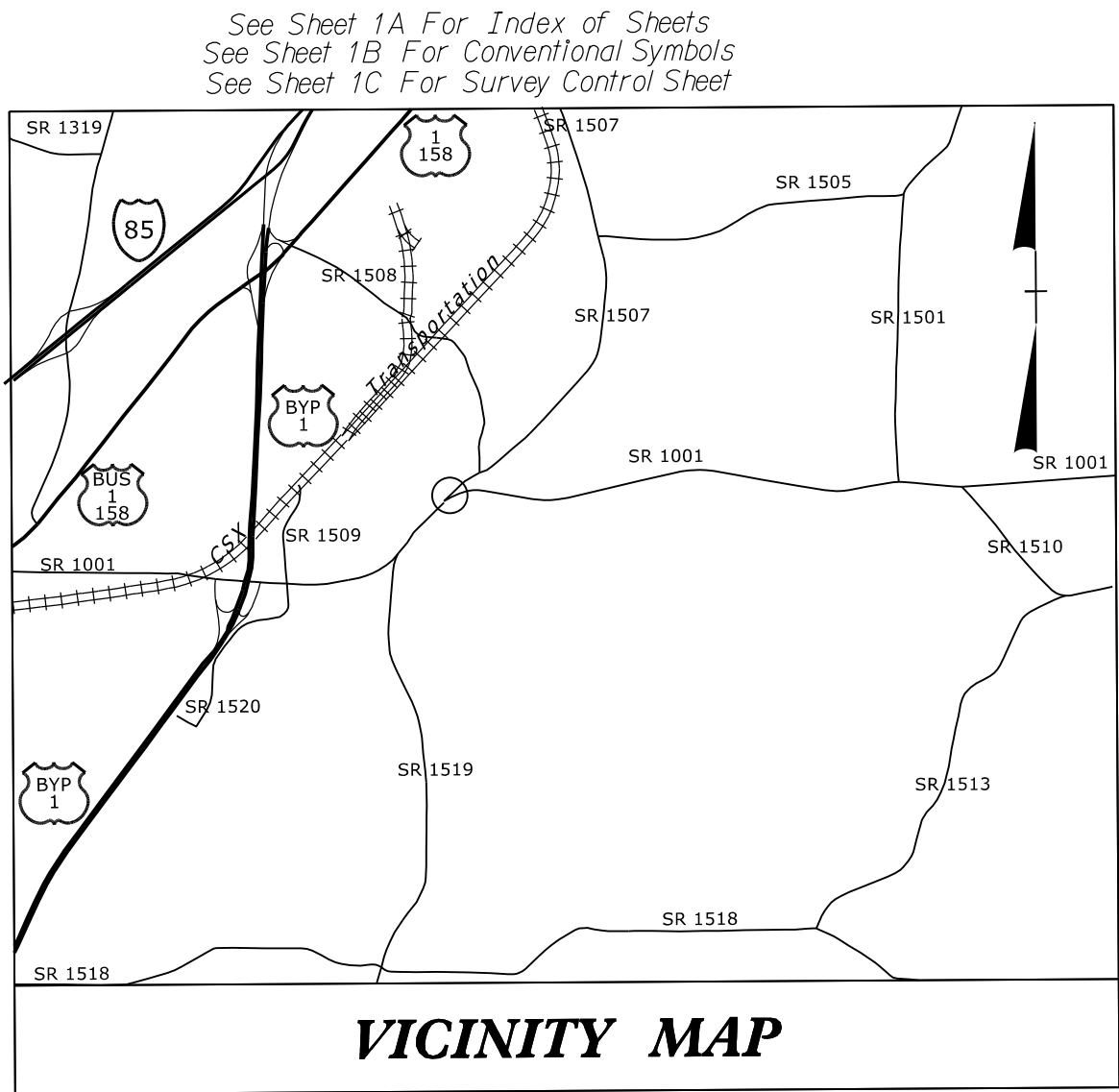

VICINITY MAP

●—●—● OFF-SITE DETOUR

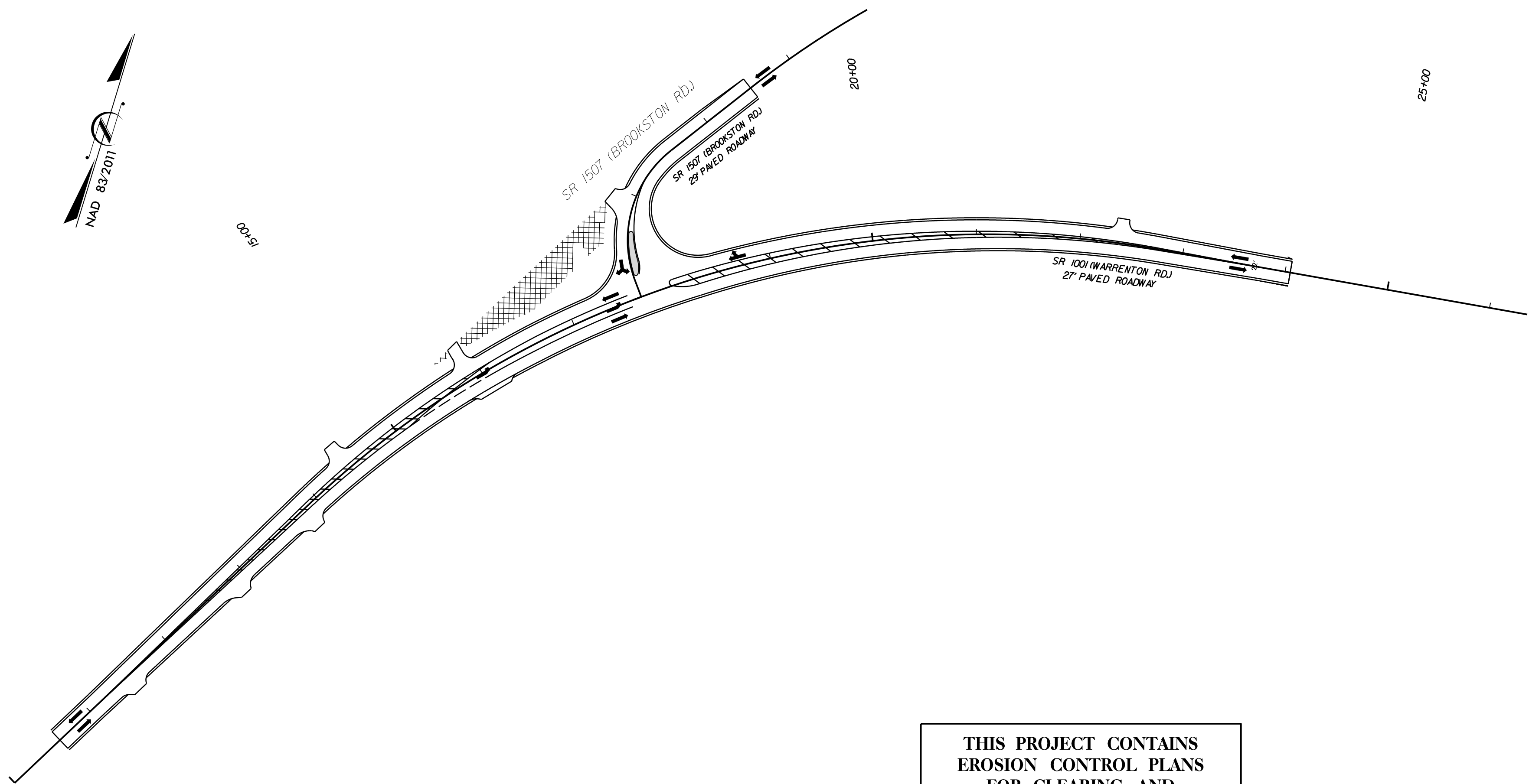

THIS PROJECT CONTAINS  
EROSION CONTROL PLANS  
FOR CLEARING AND  
GRUBBING PHASE OF  
CONSTRUCTION.

GRAPHIC SCALE

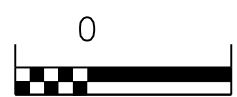

PLANS



PROFILE (HORIZONTAL)

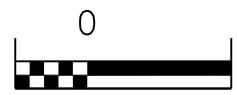

PROFILE (VERTICAL)

THESE EROSION AND SEDIMENT CONTROL PLANS COMPLY  
WITH THE REGULATIONS SET FORTH BY THE  
NCG-010000 GENERAL STORMWATER CONSTRUCTION PERMIT ISSUED BY  
THE NORTH CAROLINA DEPARTMENT OF ENVIRONMENTAL QUALITY  
DIVISION OF ENERGY, MINERAL, AND LAND RESOURCES.

Prepared In the Office of:  
**ROADSIDE ENVIRONMENTAL UNIT**  
1 South Wilmington St.  
Raleigh, NC 27611  
**2024 STANDARD SPECIFICATIONS**

Designed by:  
**David Davis** **3553**  
NAME LEVEL III CERTIFICATION NO.

Roadway Standard Drawings

The following roadway english standards as appear in "Roadway Standard Drawings"- Roadway Design Unit - N. C. Department of Transportation - Raleigh, N. C., dated January 2024 and the latest revision thereto are applicable to this project and by reference hereby are considered a part of these plans.

|         |                                  |         |                                      |
|---------|----------------------------------|---------|--------------------------------------|
| 1604.01 | Railroad Erosion Control Detail  | 1632.01 | Rock Inlet Sediment Trap Type A      |
| 1605.01 | Temporary Silt Fence             | 1632.02 | Rock Inlet Sediment Trap Type J      |
| 1606.01 | Special Sediment Control Fence   | 1632.03 | Rock Inlet Sediment Trap Type C      |
| 1607.01 | Gravel Construction Entrance     | 1633.01 | Temporary Rock Silt Check Type A     |
| 1622.01 | Temporary Berms and Slope Drains | 1633.02 | Temporary Rock Silt Check Type J     |
| 1630.01 | Riser Basin                      | 1634.01 | Temporary Rock Sediment Dam Type A   |
| 1630.02 | Silt Basin Type J                | 1634.02 | Temporary Rock Sediment Dam Type J   |
| 1630.03 | Temporary Silt Ditch             | 1635.01 | Rock Pipe Inlet Sediment Trap Type A |
| 1630.04 | Stilling Basin                   | 1635.02 | Rock Pipe Inlet Sediment Trap Type J |
| 1630.05 | Temporary Diversion              | 1640.01 | Coir Fiber Jaffle                    |
| 1630.06 | Special Stilling Basin           | 1645.01 | Temporary Stream Crossing            |
| 1631.01 | Matting Installation             |         |                                      |